

Roller Specifications

The following table lists specifications of the rollers of the press machine. Codes A through Z correspond to the codes for the rollers listed in 2-6 Roller Standard Nip Width .

If you wish to replace any of the rollers listed in the following table, refer to 2-7 Table of Rubber Roller Dimensions and provide your rubber roller supplier with exact information about the required material, dimensions, and surface finish precision.

Ink rollers

 Rollers in () are for optional specifications.

Symbol	Name (Material)	Outside diameter	Quantity	Number of spare iron cores		
				2nd unit	4th unit	5th unit
A	Form roller (rubber)	71	1 x Number of colors	1	2	2
B		68	1 x Number of colors	1	2	2
C		62	1 x Number of colors	1	2	2
D		75	1 x Number of colors	1	2	2
E	Duct roller (rubber)	60	1 x Number of colors	1	2	2
F	Distributing roller (rubber)	60	2 x Number of colors	2	4	4
G		65	2 x Number of colors	2	4	4
H		80	1 x Number of colors	1	2	2
I		82	1 x Number of colors	1	2	2
J	Oscillating roller (copper)	80.1	4 x Number of colors			
L	Ink fountain roller (steel)	90	1 x Number of colors			
M	Distributing roller (copper)	70	1 x Number of colors			
N		44	1 x Number of colors			
O		60	1 x Number of colors			
Q	Rider roller (copper)	55	1 x Number of colors			
(R)	Rider roller (copper)	42	(1 x Number of colors)			

Dampening rollers

Rollers in () are for optional specifications.

Symbol	Name (Material)	Outside diameter	Quantity	Number of spares		
				2nd unit	4th unit	5th unit
(U)	Rider roller (copper)	44.5	(1 x Number of colors)			
V	Form roller (rubber)	78	1 x Number of colors	2	4	5
W	Metering roller (rubber)	73	1 x Number of colors	2	4	5
X	Rider roller (copper)	51	1 x Number of colors			
Y	Oscillating roller (chrome)	78	1 x Number of colors			
Z	Water fountain roller (chrome)	68	1 x Number of colors			

Table of Rubber Roller Dimensions

The ink form roller (A, B, C, D) dimensions differ according to the combination of the press machine specifications and the plate dimensions.

Refer to the pages indicated in the table below for the press machine specifications and plate dimensions.

Specifications	Model	Plate dimensions	Page
Standard	E-29	605 x 760 mm (standard)	2-8 When plate dimensions are 605 x 760 mm (standard) (E-29)
		605 x 745 mm (option)	2-10 When plate dimensions are 605 x 745 mm (option) (E-29)
	E-26	560 x 670 mm	2-12 When plate dimensions are 560 x 670 mm (E-26)
Anti-ghost roller (option)	E-29W	605 x 765 mm	2-14 When plate dimensions are 605 x 765 mm (E-29W)
	E-29	605 x 760 mm (standard)	2-16 When plate dimensions are 605 x 760 mm (standard) (E-29)
		605 x 745 mm (option)	2-18 When plate dimensions are 605 x 745 mm (option) (E-29)
	E-26	560 x 670 mm	2-20 When plate dimensions are 560 x 670 mm (E-26)
	E-29W	605 x 765 mm	2-22 When plate dimensions are 605 x 765 mm (E-29W)

The dampening form roller (V) dimensions differ according to the combination of the plate dimensions. Refer to the pages indicated in the table below for the plate dimensions.

Model	Plate dimensions	Page
E-29	605 x 760 mm (standard)	2-26 When plate dimensions are 605 x 760 mm (standard) (E-29) and when plate dimensions are 605 x 765 mm (E-29W)
	605 x 745 mm (option)	2-26 When plate dimensions are 605 x 745 mm (option) (E-29)
E-26	560 x 670 mm	2-26 When plate dimensions are 560 x 670 mm (E-26)
E-29W	605 x 765 mm	2-26 When plate dimensions are 605 x 760 mm (standard) (E-29) and when plate dimensions are 605 x 765 mm (E-29W)

When plate dimensions are 605 × 745 mm (option) (E-29)

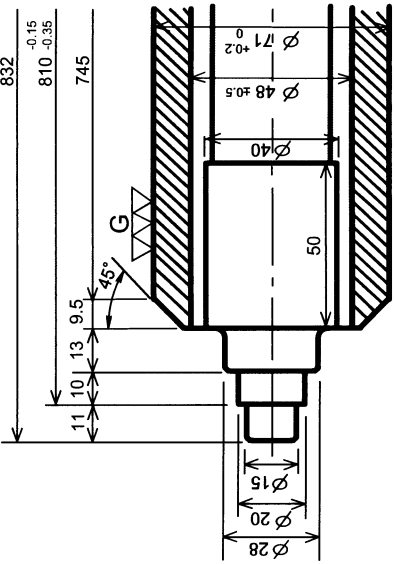
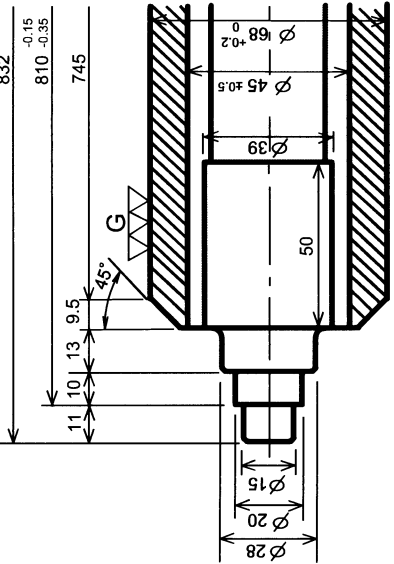
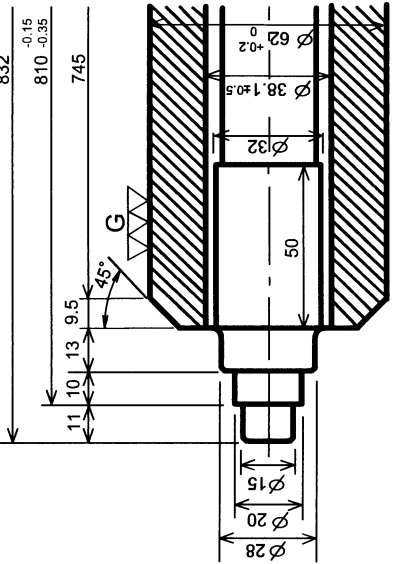
Code	Name	Part No.	Bearing
A	1st form roller	TIZ4900101	6202ZZ  Rubber hardness: 30° ± 2° Error of roundness: 0.02 max. ROP00466
B	2nd form roller	TIZ4900201	6202ZZ  Rubber hardness: 30° ± 2° Error of roundness: 0.02 max. ROP00467
C	3rd form roller	TIZ4900301	6202ZZ  Rubber hardness: 30° ± 2° Error of roundness: 0.02 max. ROP00468

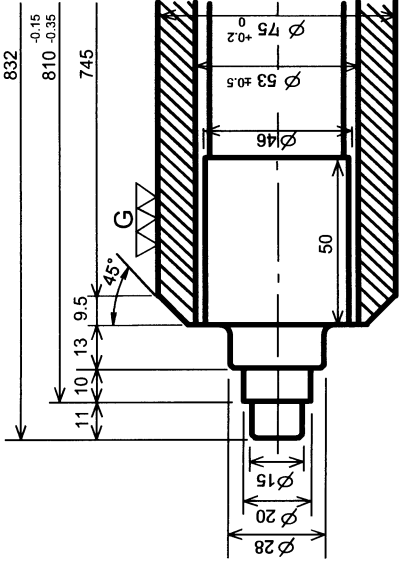
Code	Name	Part No.	Bearing
D	4th form roller	TIZ4900401	<p>6202ZZ</p>  <p>Rubber hardness: $30^\circ \pm 2^\circ$ Error of roundness: 0.02 max.</p> <p>ROP00469</p>

When plate dimensions are 560 x 670 mm (E-26)

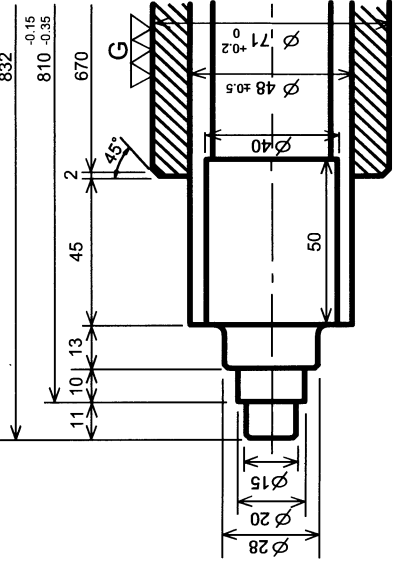
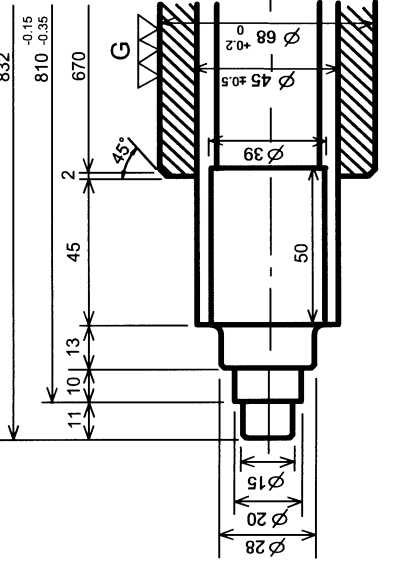
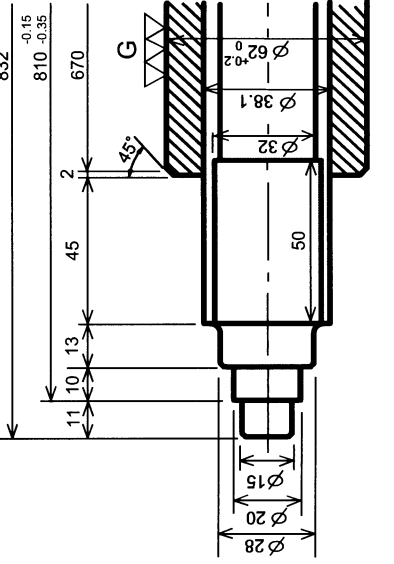
Code	Name	Part No.	Bearing
A	1st form roller	6444900101	 <p data-bbox="750 422 817 742">Rubber hardness: 30° ± 2° Error of roundness: 0.02 max.</p> <p data-bbox="728 263 750 343">ROP00483</p>
B	2nd form roller	6444900201	 <p data-bbox="1254 406 1321 742">Rubber hardness: 30° ± 2° Error of roundness: 0.02 max.</p> <p data-bbox="1232 263 1254 343">ROP00484</p>
C	3rd form roller	6444900301	 <p data-bbox="1747 406 1814 742">Rubber hardness: 30° ± 2° Error of roundness: 0.02 max.</p> <p data-bbox="1724 263 1747 343">ROP00485</p>

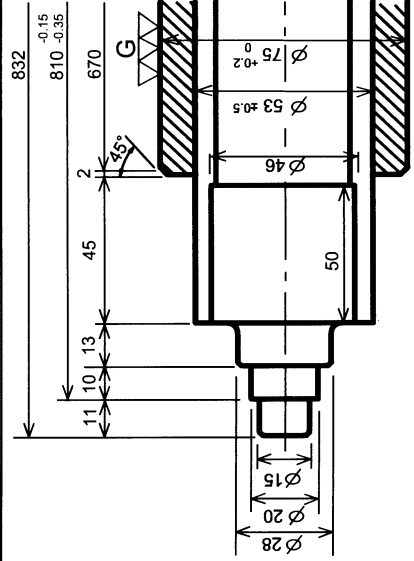
Code	Name	Part No.	Bearing
D	4th form roller	6444900401	<p data-bbox="181 129 215 220">6202ZZ</p>  <p data-bbox="607 261 629 341">ROP00486</p> <p data-bbox="629 405 689 746">Rubber hardness: 30° ± 2° Error of roundness: 0.02 max.</p>

Symbol	Name	Part No.	Bearing /
D	4th form roller	RIH4900102	6202ZZ
<p>Technical drawing of a 4th form roller. The drawing shows a cross-section of the roller with various dimensions and specifications. The roller has an outer diameter of $\varnothing 20$ and an inner diameter of $\varnothing 15$. The total length is 832, with a distance of 764 from the left end to the center of the roller. The roller is mounted on a shaft with a diameter of $\varnothing 55 \pm 0.5$. The roller has a 45-degree chamfered edge with a thickness of 2. The distance from the left end to the start of the roller is 11, and the distance from the start of the roller to the center of the roller is 23. The roller is labeled 'G' and 'ROP00113'. The specifications are: Rubber hardness: $30 \pm 2^\circ$, Error of roundness: 0.02 max.</p>			

Symbol	Name	Part No.	Bearing
D	4th form roller	RIL4900101	6202ZZ

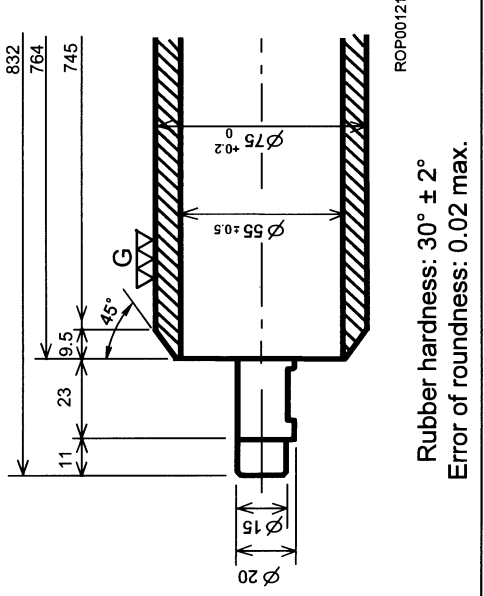

When plate dimensions are 560 x 670 mm (E-26)

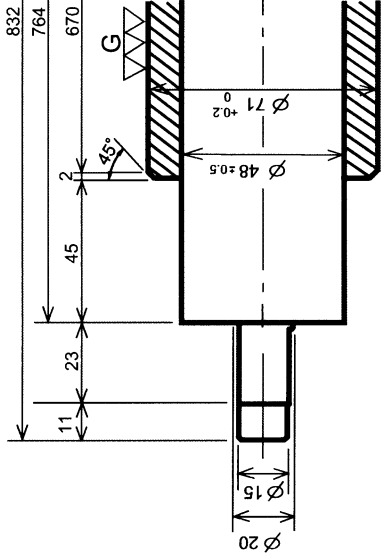
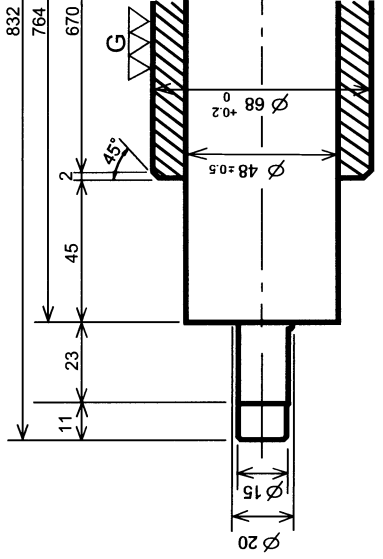
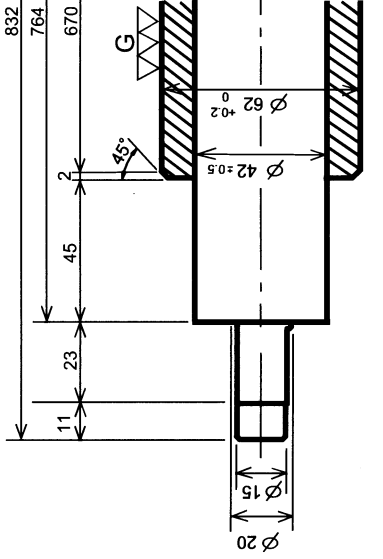
Symbol	Name	Part No.	Bearing
A	1st form roller	RJJ4900101	6202ZZ  Rubber hardness: 30° ± 2° Error of roundness: 0.02 max. ROP00204
B	2nd form roller	RJJ4900101	6202ZZ  Rubber hardness: 30° ± 2° Error of roundness: 0.02 max. ROP00154
C	3rd form roller	RJK4900100	6202ZZ  Rubber hardness: 30° ± 2° Error of roundness: 0.02 max. ROP00155

Symbol	Name	Part No.	Bearing
D	4th form roller	RJL4900101	6202ZZ
			<p>Rubber hardness: 30° ± 2° Error of roundness: 0.02 max.</p> <p>ROP00156</p>

Code	Name	Part No.	Bearing
D	4th form roller	RJG4900100	6202ZZ

Rubber hardness: 30° ± 2°
 Error of roundness: 0.02 max.

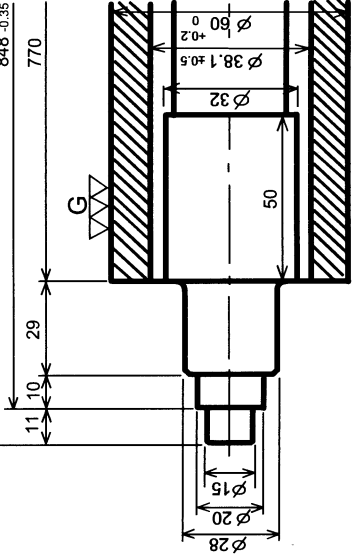
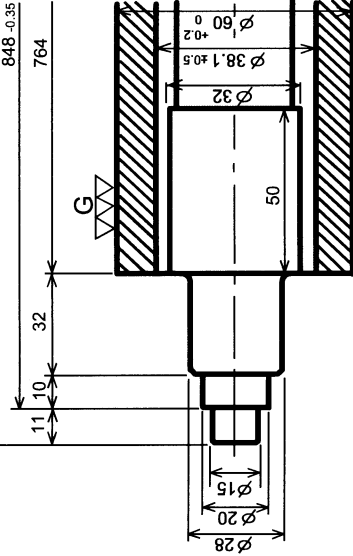
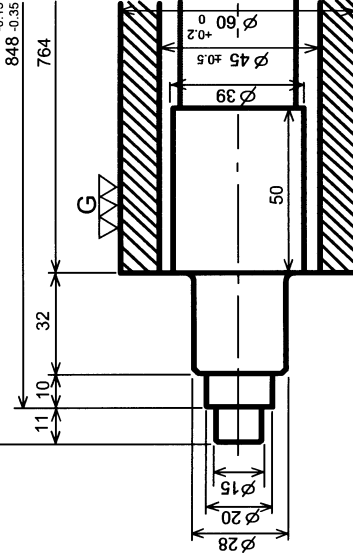
Code	Name	Part No.	Bearing
E	Duct roller	8144901104	6202ZZ
 <p style="text-align: center;"> Rubber hardness: 30° ± 2° Error of roundness: 0.02 max. </p>			
F	Distributing roller	8144901003	6202ZZ
 <p style="text-align: center;"> Rubber hardness: 30° ± 2° Error of roundness: 0.02 max. </p>			
G	Distributing roller	8144900504	6202ZZ
 <p style="text-align: center;"> Rubber hardness: 30° ± 2° Error of roundness: 0.02 max. </p>			

Code	Name	Part No.	Bearing*
H	Distributing roller	8144901303	6202ZZ ROP00477 Rubber hardness: 30° ± 2° Error of roundness: 0.02 max.
I	Distributing roller	8144900703	6202ZZ ROP00478 Rubber hardness: 30° ± 2° Error of roundness: 0.02 max.
W	Metering roller	8145900203	6202-2RU ROP00479 Rubber hardness: 25° ± 2° Error of roundness: 0.02 max.

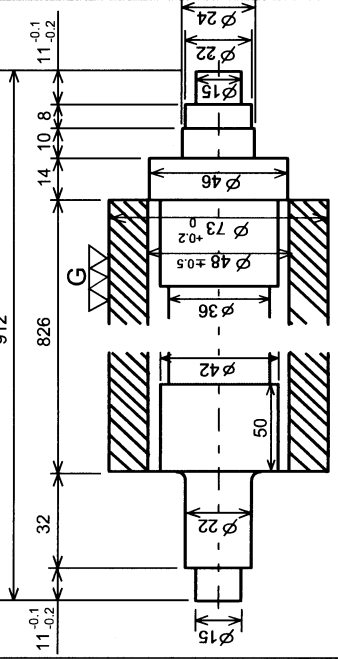
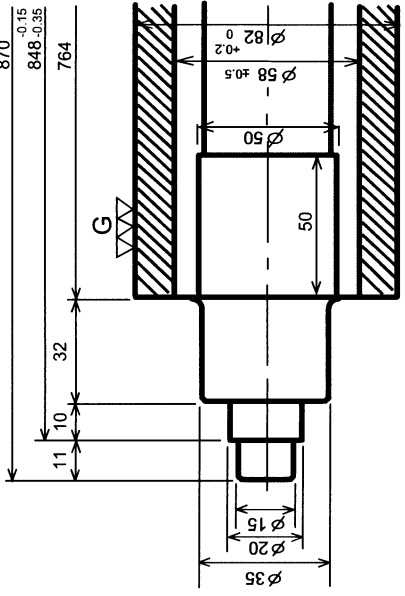
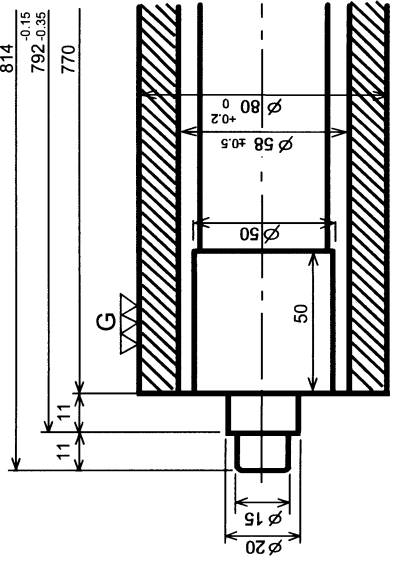

Specifications

The information and the values of specifications may vary depending on the demanded printing quality, the installation and operating environments of the press machine, and the condition of printing materials such as ink, water, plate, and paper, etc.

1. Major dimensions

	Model	E-26	E-29		E-29W
			Standard	Options	
A	Maximum paper size	480 × 660 mm	530 × 750 mm		546 × 765 mm
	Minimum paper size		200 × 280 mm		
	Paper thickness		0.04 to 0.6 mm		
B	Maximum printing area	470 × 650 mm	520 × 740 mm	520 × 736 mm	535 × 755 mm
C	Plate dimensions	560 × 670 mm	605 × 760 mm	605 × 745 mm	605 × 765 mm
D	Blanket dimensions	688 × 770 mm (including aluminum bar)			688 × 765 mm (including aluminum bar)
		Cylinder dimensions			
E	Plate cylinder	Ø220			
	Blanket cylinder	Ø220			
	Impression cylinder	Ø440			

2. Press dimensions

	Height		Width	Length	Foundation dia-gram number
	Safety cover closed	Safety cover opened			
2-color model	1,770 mm	2,055 mm	2,582 mm (2,632 mm*2)	4,762 mm (5,227 mm*3)	852-B001-0
4-color model	(2,135 mm*1)	(2,135 mm*1)		6,322 mm (6,787 mm*3)	854-B001-0
5-color model	(2,294 mm*3)	(2,294 mm*3)		7,354 mm (7,819 mm*3)	855-B003-0

The value indicated with “*1” is the height up to the upper bar of the operation stand.

The value indicated with “*2” is the width for the specification of the wide operation side auxiliary footboard.

The value indicated with *3 is the height and length up to the bar at the PQC operation stand upper fluorescent lamp (extended parallel illumination type) specifications.

3. Weight

2-color model	4-color model	5-color model
8,100 kg	14,300 kg	17,400 kg

4. Speed

Maximum printing speed	13,000 sheets/hour
Minimum printing speed	3,000 sheets/hour